

# \$195,000 - Rr35, Rural Red Deer County

MLS® #A2147716

**\$195,000**

0 Bedroom, 0.00 Bathroom,  
Land on 5.00 Acres

NONE, Rural Red Deer County, Alberta

Build your dream home and landscaping on this 5 acre parcel. 2 story building has potential for mountain views. Just off of Highway 587 with very little gravel driving. Close to Eagle hill CO-OP. 5 Acres have been subdivided off of a hay field. Enjoy this quiet location with access to Old's, Sundre or Bowden.

## Essential Information

MLS® #	A2147716
Price	\$195,000
Bathrooms	0.00
Acres	5.00
Type	Land
Sub-Type	Residential Land
Status	Active

## Community Information

Address	Rr35
Subdivision	NONE
City	Rural Red Deer County
County	Red Deer County
Province	Alberta
Postal Code	T0M 0K0

## Amenities

Utilities	None
-----------	------

## Additional Information

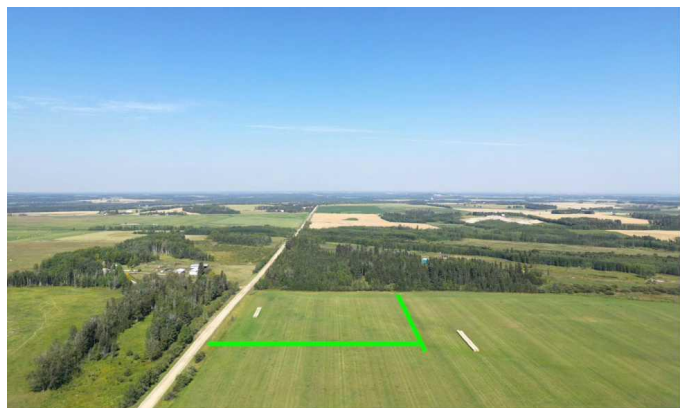

Date Listed	July 8th, 2024
Days on Market	288
Zoning	AG - agricultural

### **Listing Details**

Listing Office	Century 21 Bravo Realty
----------------	-------------------------

Data is supplied by Pillar 9â,,ç MLSÂ® System. Pillar 9â,,ç is the owner of the copyright in its MLSÂ® System. Data is deemed reliable but is not guaranteed accurate by Pillar 9â,,ç. The trademarks MLSÂ®, Multiple Listing ServiceÂ® and the associated logos are owned by The Canadian Real Estate Association (CREA) and identify the quality of services provided by real estate professionals who are members of CREA. Used under license.